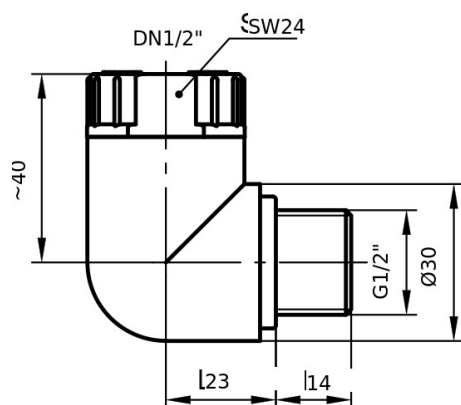



Illustration exemplary



All data in mm; Illustration exemplary

## 1W+200MG1812PF

Elbow connector for corrugated tube, with series 1W+ tube connection and male G-thread

### Technical data

Connection A	DN1/2"
Connection B	G1/2"
Material Body	PFA
Material Pressure Screw	PFA
Pressure Stage	PN4
Max. Media Temperature	180°C

Starting from the nominal pressure rating (at 20°C), the permissible pressure reduces with increasing media temperature.